



### Order example

PCHC □ – 20 – □ N

Model	Tube ID.	Style (*1)	Type (*2)
MCHC (Standard stroke)	6	Blank: Double acting	Blank: Standard 1: Side tapped mounting 2: Standard (Through hole)
	10	Blank: Double acting S: Single acting / Normally open C: Single acting / Normally closed	Blank: Standard 1: Side tapped mounting 2: Standard (Through hole) 3: Flat N: Narrow N1: Narrow type side tapped mounting N2: Narrow (Through hole)
	16		
	20		
25			
MCHCL (Long stroke)	10 16 20 25	Blank: Double acting	Blank: Standard 1: Side tapped mounting 2: Standard (Through hole)

#### \*1. STYLE

Blank: Double acting	S: Single acting / Normally open	C: Single acting / Normally closed

#### \*2. TYPE

Blank: Standard	1: Side tapped mounting	2: Standard (Through hole)	3: Flat
N: Narrow	N1: Narrow type side tapped mounting	N2: Narrow (Through hole)	

### Features

- Integral linear guide used for high rigidity and high precision.
- The material of finger is martensitic stainless steel.
- Body thickness tolerance  $\pm 0.05\text{mm}$ .
- Bottom pin holes for accurate re-locating.
- Grooves on the body for sensor switch to be inserted into.
- The gripping stroke of long-stroke type is approximately double compare with standard type.
- Magnetic as standard.

### Specification

Model		PCHC					
Acting type		Double acting / Single acting					
Tube I.D. (mm)		6	10	16	20	25	
Opening / Closing stroke (mm)		4	4(8)	6(12)	10(18)	14(22)	
Port size		M3×0.5		M5×0.8			
Medium		Air					
Operating pressure range (MPa)	Double acting	0.15~0.7	0.2~0.7	0.1~0.7			
	Single acting	–	0.35~0.7	0.25~0.7			
Ambient temperature		-10~+60°C (No freezing)					
Repeatability		$\pm 0.01\text{ mm}$					
Max. operating frequency (c.p.m)		180 (120)					
Lubricator		Not required					
Sensor switch (*2)		*1	RDE, RDE-D: Non-contact				
Weight (g)	Double acting	Standard	27	55	124	250	461
		Long stroke	–	56	125	252	463
	Single acting	Flat type	–	53	124	244	450
		Standard	–	70	145	270	490

\*1. Tube I.D.  $\phi 6$  use RDFE(V) sensor switch.

\*2. ( ) value for long stroke.

### Gripping force

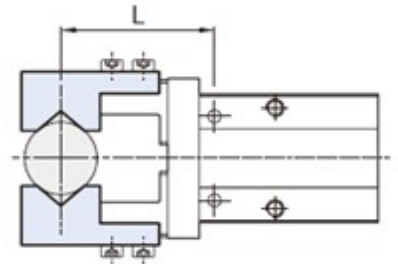

Tube I.D. (mm)		6	10	16	20	25
Double acting	External	3.3(0.3)	11(1.1)	34(3.5)	42(4.3)	65(6.6)
	Internal	6.1(0.6)	17(1.7)	45(4.6)	66(6.7)	104(10.6)
Single acting / Normally open	External	–	7.1(0.7)	27(2.8)	33(3.4)	45(4.6)
	Internal	–	13(1.3)	38(3.9)	57(5.8)	83(8.5)

\* Operation pressure 0.5 MPa, gripping length 20mm, the effective gripping force for each finger is \*\*\* N(kgf).