

PAF302 series AIR UNIT (FILTER)



■ Specification

Model	PAF302		
Bore No.	8A	10A	15A
Port size	1/4	3/8	1/2
Medium	Air		
Operating pressure range (*)	0.05~1 MPa		
Proof pressure	1.5 MPa		
Ambient temperature	- 5~+60°C (No freezing)		
Filter element	Standard: 5μm, Option: 40μm		
Drain capacity	35 cm ³		
Weight	335 g		

Symbol

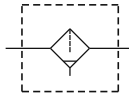

* Standard unit contains semi-auto-drain function when operating pressure below 0.05 MPa.

* Choose auto-drain FMRF300, the pressure range is 0.15~1 MPa.

■ Order example

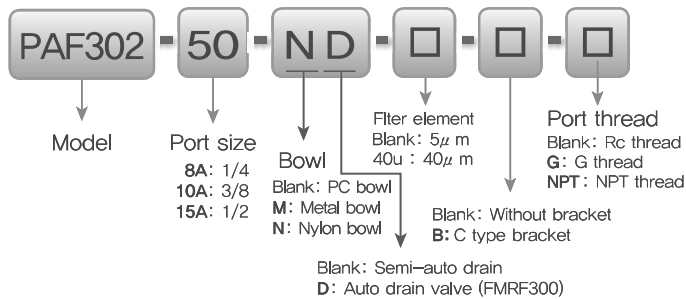

■ Flow feature

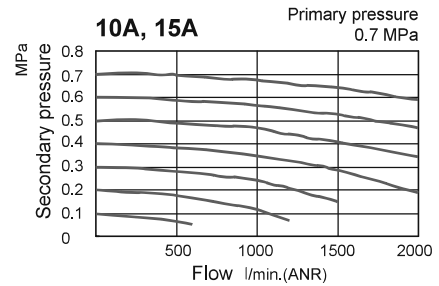
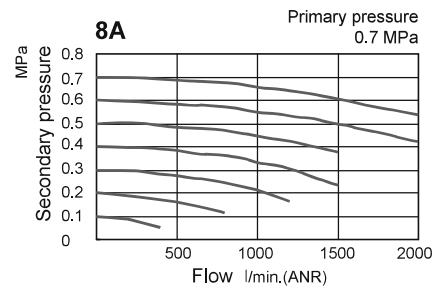

■ Option accessories

C type bracket

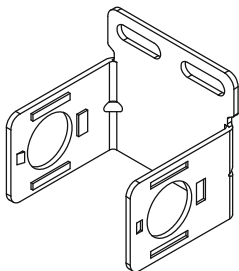

⚠ Caution

Metal bowl

Before assembling or disassembling, push the lock plate down to the end, and confirm that is detached from the body then rotate the bowl, otherwise the lock plate will be deformed or the body will be scratched.

1. Sliding plate down

2. Rotating the bowl

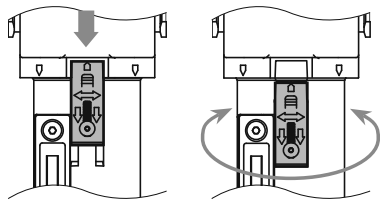

Dimensions

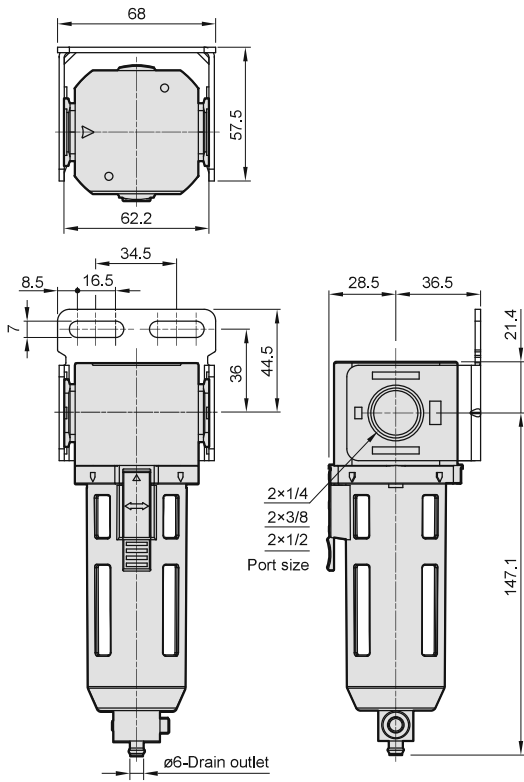

PAF302-D

Auto drain valve

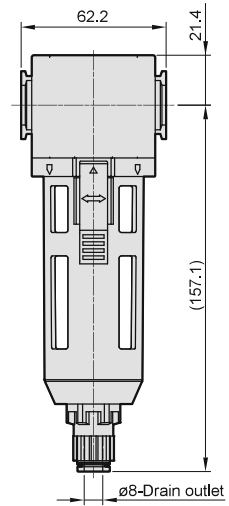

PAF302-M

Metal bowl

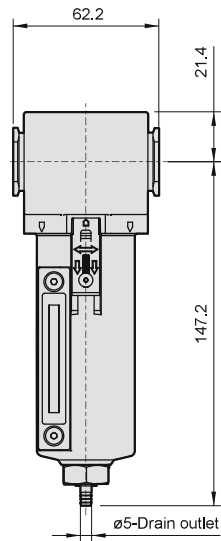

PAF302-MD

Metal bowl + Auto drain valve

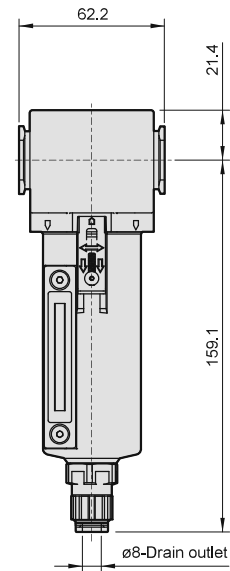

PAF401 series AIR UNIT (FILTER)



Symbol

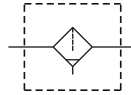

■ Specification

Model	PAF401		
Bore No.	8A	10A	15A
Port size	1/4	3/8	1/2
Medium	Air		
Operating pressure range (*1.2)	0.05~1.5 MPa		
Proof pressure	2 MPa		
Ambient temperature	- 5~+60°C (No freezing)		
Filter element	Standard: 40μm, Option: 5μm		
Drain capacity	70 cm ³		
Max. flow rate(*3) l /min.(ANR)	1500	2000	2500
Weight	480 g		

*1. Standard unit contains semi-auto-drain function when operating pressure below 0.05 MPa.

*2. Choose auto-drain FMRF300, the pressure range is 0.15~1 MPa.
 $\Delta P=0.03$ MPa.

■ Order example

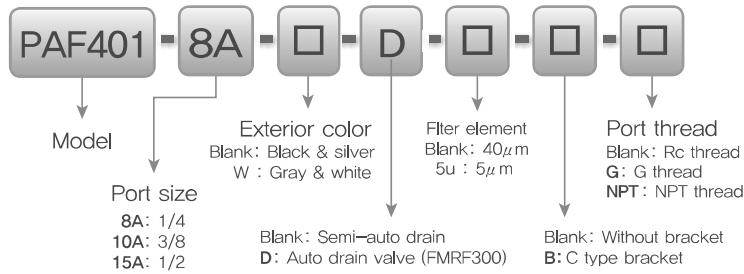

■ Flow feature

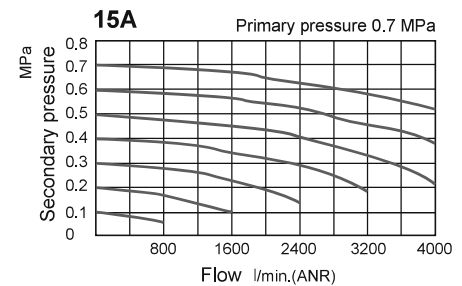
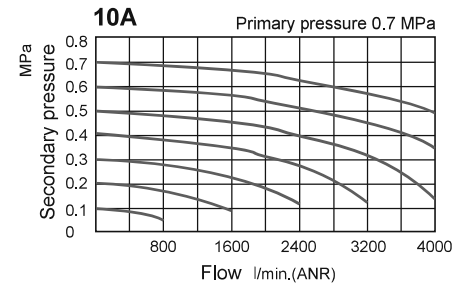
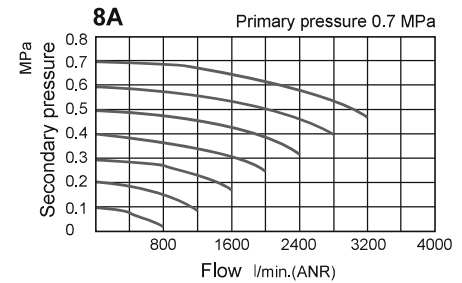

■ Option accessories

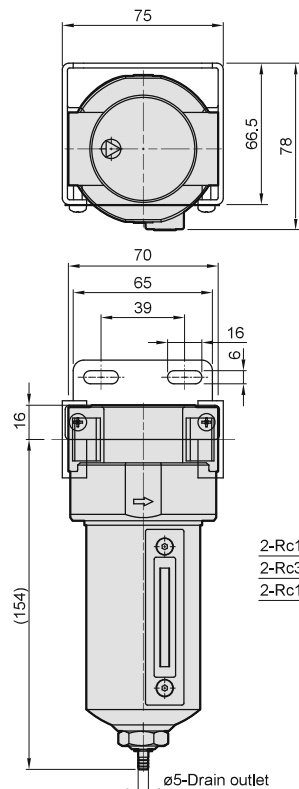
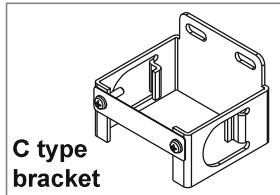

PAF501 series AIR UNIT (FILTER)



Symbol

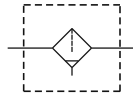

■ Specification

Model	PAF501	
Bore No.	20A	25A
Port size	3/4	1
Medium	Air	
Operating pressure range (*)	Nylon bowl, PC bowl: 0.05~1 MPa	
	Metal bowl: 0.05~1.5 MPa	
Proof pressure	Nylon bowl, PC bowl: 1.5 MPa	
	Metal bowl: 2 MPa	
Ambient temperature	- 5~+60°C (No freezing)	
Filter element	40 μm	
Drain capacity	Nylon bowl, PC bowl: 75 cm ³	
	Metal bowl: 70 cm ³	
Weight	Nylon bowl, PC bowl: 1180g	
	Metal bowl: 1300g	

* Standard unit contains semi-auto-drain function when operating pressure below 0.05 MPa.

* Choose auto-drain FMRF300, the pressure range is 0.15~1 MPa.

■ Order example

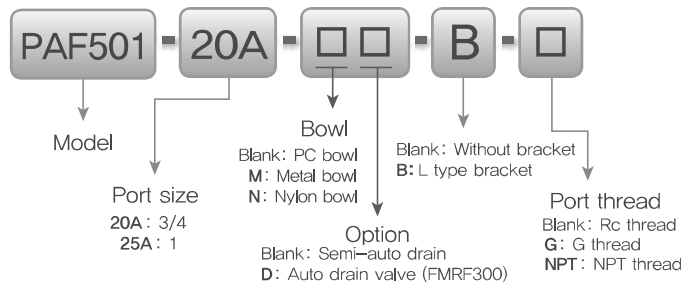

■ Option accessories

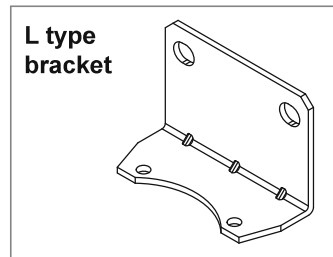

■ Flow feature

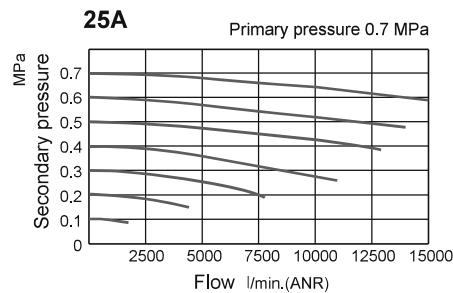
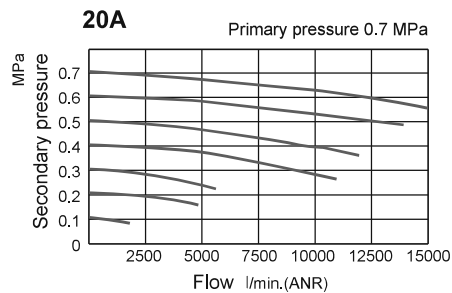

Dimensions

