

# PACT302 series AIR UNIT (F.R.L.UNIT)

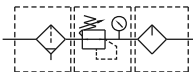

Option: MP41

### Symbol



### Specification

Model	PACT302		
Components	PAF302, PAR302, PAL302		
Bore No.	8A	10A	15A
Port size	1/4	3/8	1/2
Medium	Air		
Operating pressure range (*)	0.05~1 MPa		
Proof pressure	1.5 MPa		
Effective orifice	32mm <sup>2</sup>	34mm <sup>2</sup>	
Regulated pressure range	0.05~0.85 MPa		
Ambient temperature	- 5~+60°C (No freezing)		
Filter element	Standard: 5μm, Option: 40μm		
Lubricating oil capacity	65c.c		
Min. flow for oil drip	50 l/min	60 l/min	
Recommended lubricating oil	Turbine oil ISO-VG32		
Attachment	Pressure gauge (PG-20), T-type bracket		
Weight	1115 g		

\* Standard unit contains semi-auto-drain function when operating pressure below 0.05 MPa.

\* Choose auto-drain FMRF300, the pressure range is 0.15~1 MPa.

### Order example

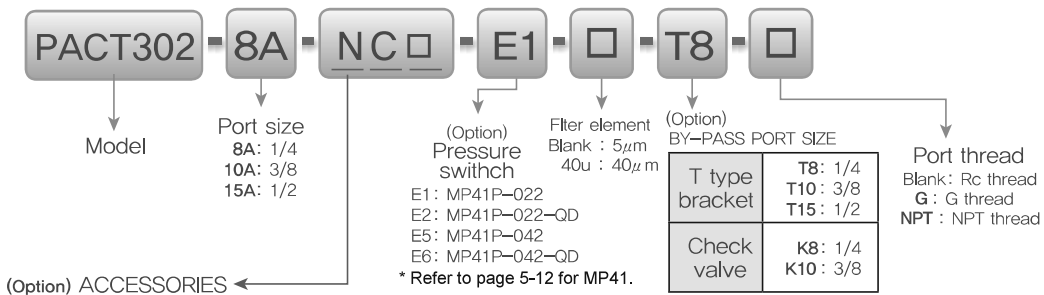

Bowl	Pressure gauge	Drain valve
Blank: PC bowl M: Metal bowl N: Nylon bowl	Blank: Pressure gauge (PG-20) C: External pressure gauge (PG-40) + Gauge adapter set (A-PAR302) A: Gauge adapter set (A-PAR302)	Blank: Semi-auto drain D: Auto drain valve (FMRF300)

\* PG-40 (C) and MP41 (E\*) can not be selected at the same time.

\* Be sure to use above check valves when redirecting the air flow on the inlet side of the lubricator.

### Flow feature

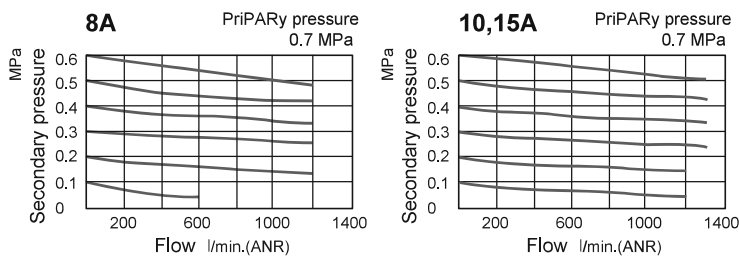

### Caution

#### Metal bowl

Before assembling or disassembling, push the lock plate down to the end, and confirm that is detached from the body then rotate the bowl, otherwise the lock plate will be deformed or the body will be scratched.

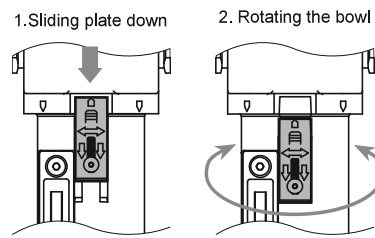

## Accessories

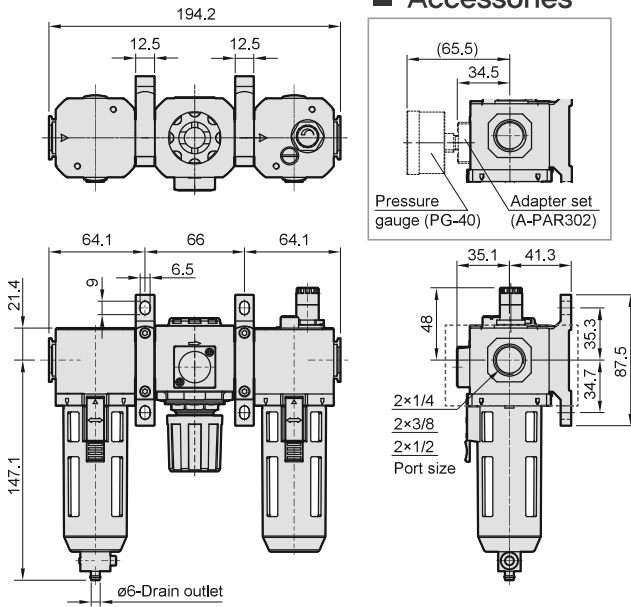

### PACT302-D\*

Auto drain valve

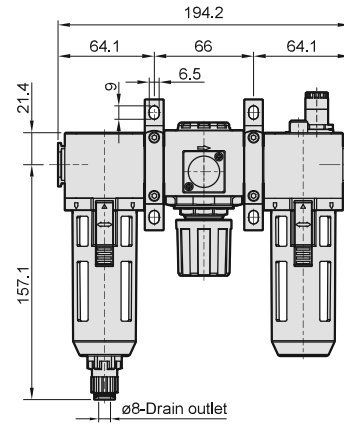

### PACT302-T\*

T type bracket

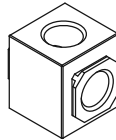
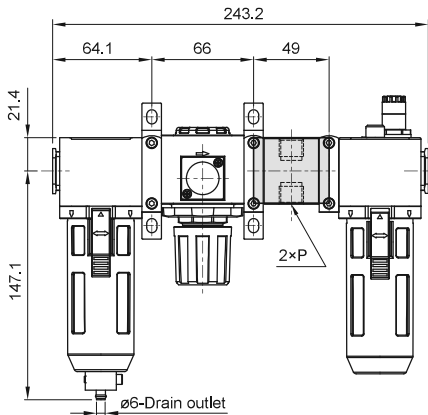

Port Bracket	P
T8	1/4
T10	3/8
T15	1/2

### PACT302-M\*

Metal bowl

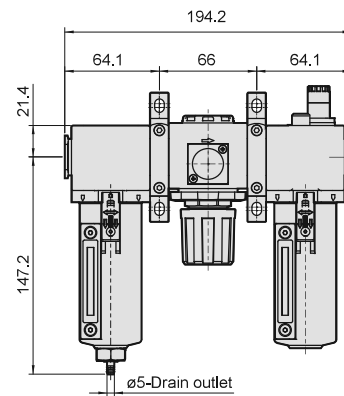

### PACT302-K\*

Check valve

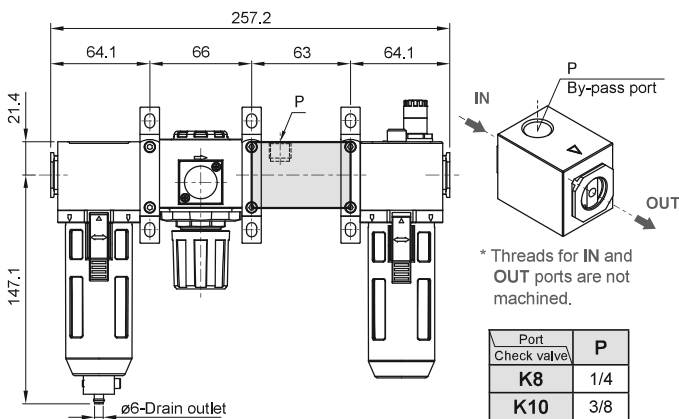

Port Check valve	P
K8	1/4
K10	3/8

### PACT302-DM\*

Auto drain valve + Metal bowl

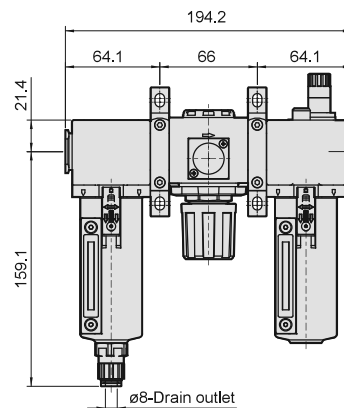

# PACT401 series AIR UNIT (F.R.L.UNIT)

## ■ Specification

Model	PACT401		
Components	PMF401, PAR401, a401		
Bore No.	8A	10A	15A
Port size	1/4	3/8	1/2
Medium	Air		
Operating perssure range (*)	0.05~1.5 MPa		
Proof pressure	2 MPa		
Regulated pressure range	Standard: 0.1~0.85 MPa High pressure: 0.1~1.5 MPa		
Ambient temperature	- 5~+60°C (No freezing)		
Filter element	Standard: 40μm, Option: 5μm		
Lubricating oil capacity	200c.c		
Min. flow for oil drip	30 l/min	65 l/min	80 l/min
Recommended lubricating oil	Turbine oil ISO-VG32		
Attachment	Pressure gauge (PG-20), L-type bracket		
Weight	1812 g		



Option: **MP41**

## Symbol

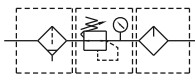

\* Standard unit contains semi-auto-drain function when operating pressure below 0.05 MPa.

\* Choose auto-drain FMRF300, the pressure range is 0.15~1 MPa.

## ■ Order example

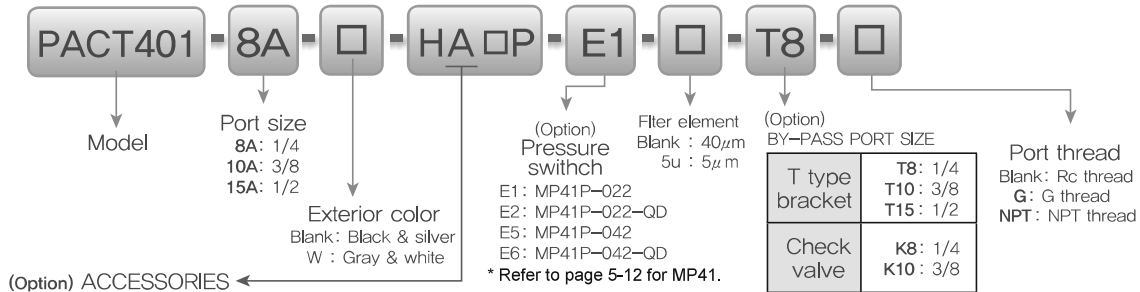

Type	Pressure gauge	Drain valve	Pressure switch
Blank: Standard type	Blank: Pressure gauge (PG-20) C: External pressure gauge (PG-40) + Gauge adapter set (A-PAR401) A: Gauge adapter set (A-PAR401)	Blank: Semi-auto drain D: Auto drain valve (FMRF300)	P: Pressure switch (MPS series)
H: High pressure type	C: External pressure gauge (PG-40) + Gauge adapter set (A-PAR401) A: Gauge adapter set (A-PAR401)	Blank: Semi-auto drain	

\* PG-40 (C) and MP41 (E\*) can not be selected at the same time.  
\* PAR401-W pressure gauge with set (A-PAR302).

\* Be sure to use above check valves when redirecting the air flow on the inlet side of the lubricator.

## ■ Flow feature

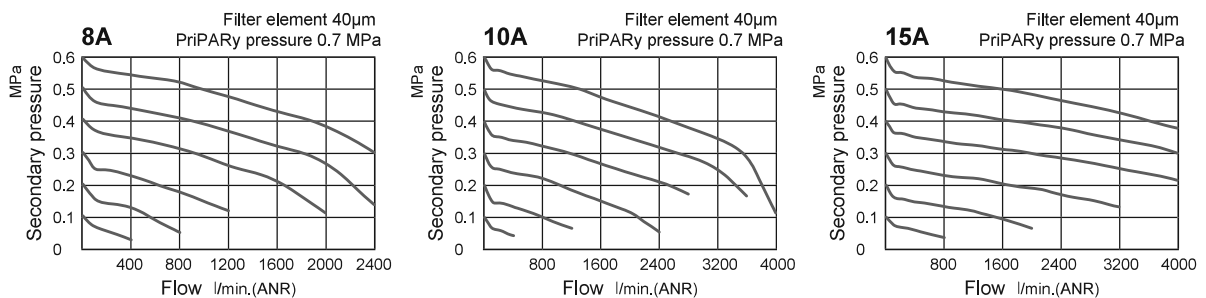

# Dimensions

## Accessories

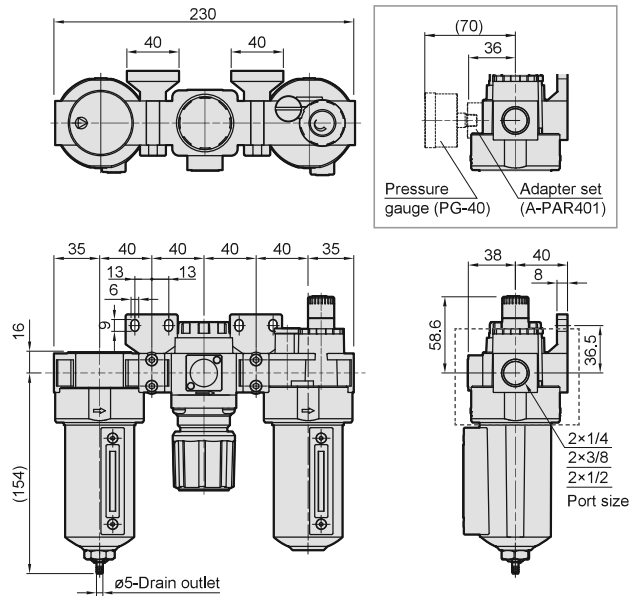

## PACT401-D

Auto drain valve

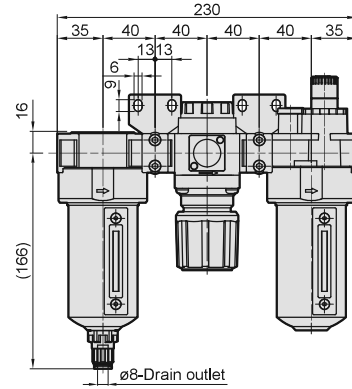

## PACT401-T\*

T type bracket

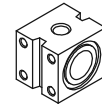
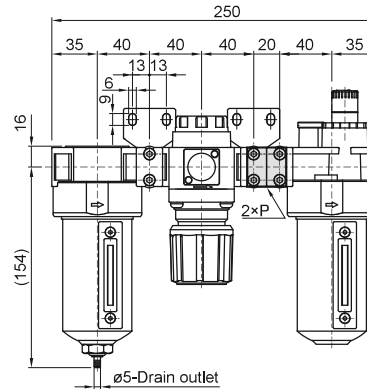

Port Bracket	P
T8	1/4
T10	3/8
T15	1/2

## PACT401-K\*

Check valve

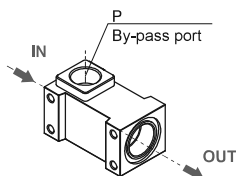
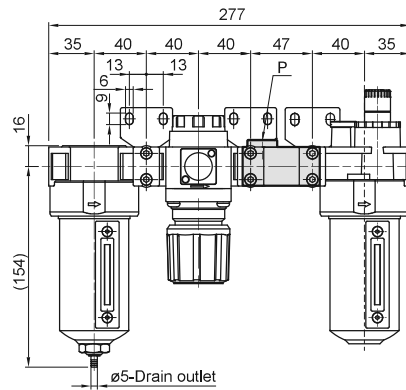

Port Check valve	P
K8	1/4
K10	3/8

\* Threads for IN and OUT ports are not machined.

## PACT401-P

MPS Series pneumatic pressure switch

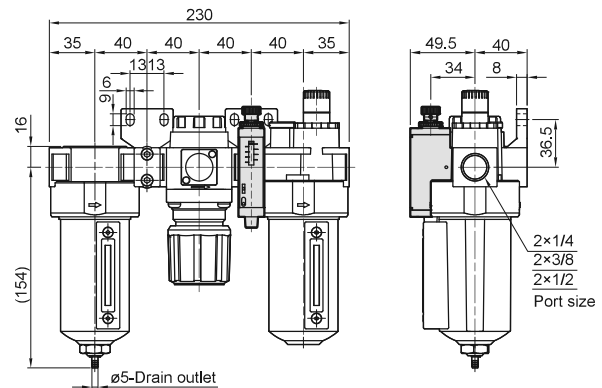

# PACT501 series AIR UNIT (F.R.L.UNIT)

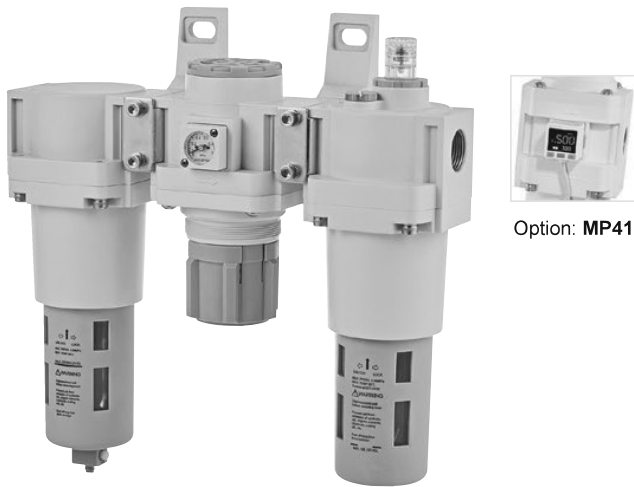

Option: MP41

## Symbol

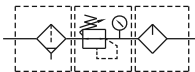

## Specification

Model	PACP501	
Components	PAF501, PAR501, PAL501	
Bore No.	20A	25A
Port size	3/4	1
Medium	Air	
Operating pressure range (*)	0.05~1 MPa	
Proof pressure	1.5 MPa	
Regulated pressure range	0.05~0.85 MPa	
Ambient temperature	- 5~+60°C (No freezing)	
Filter element	40μm	
Lubricating oil capacity	200c.c	
Min. flow for oil drip	25 l/min	33 l/min
Recommended lubricating oil	Turbine oil ISO-VG32	
Attachment	Pressure gauge (PG-20), bracket	
Weight	Nylon bowl, PC bowl: 4200 g	
	Metal bowl: 4440 g	

\* Standard unit contains semi-auto-drain function when operating pressure below 0.05 MPa.

\* Choose auto-drain FMRF300, the pressure range is 0.15~1 MPa.

## Order example

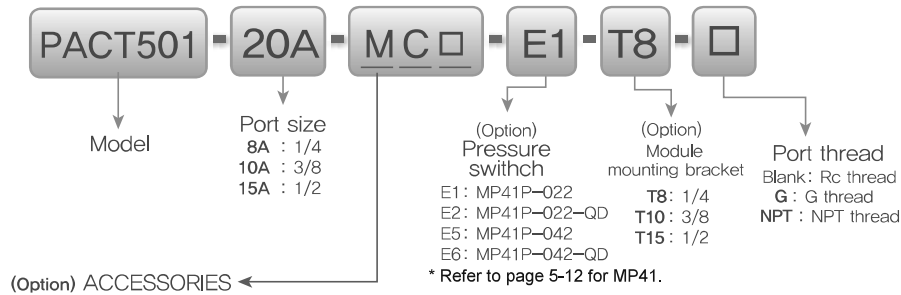

Bowl	Pressure gauge	Drain valve
Blank: PC bowl M: Metal bowl N: Nylon bowl	Blank: Pressure gauge (PG-20) C: External pressure gauge (PG-40) + Gauge adapter set (A-PAR302) A: Gauge adapter set (A-PAR302)	Blank: Semi-auto drain D: Auto drain valve (FMRF300)

\* PG-40 (C) and MP41 (E\*) can not be selected at the same time.

## Flow feature

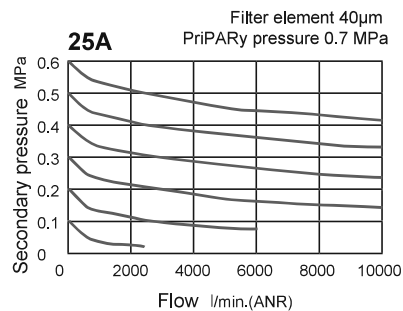
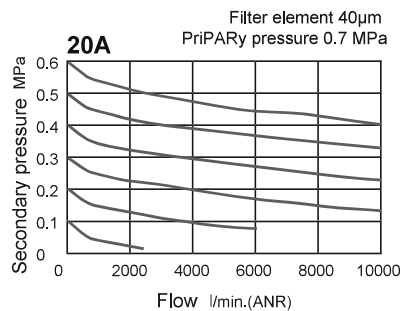

# Dimensions

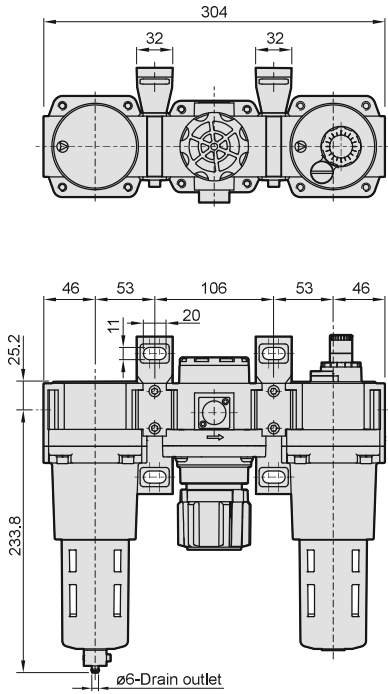

**PACT501-M**  
Metal bowl

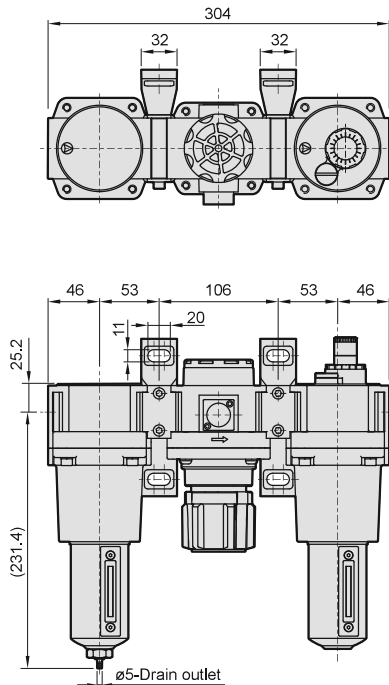

## Accessories

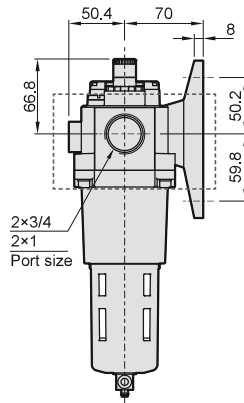
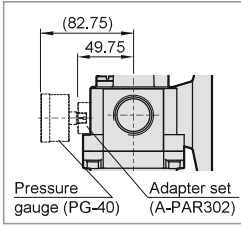

**PACT501-D**  
Auto drain valve

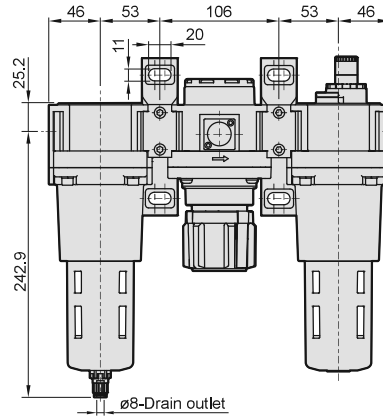

**PACT501-T\***  
T type bracket

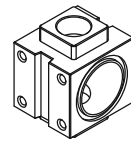
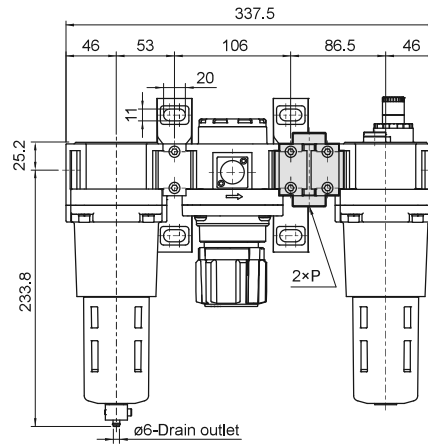

Port Bracket	P
T8	1/4
T10	3/8
T15	1/2

**PACT501-MD**  
Metal bowl + auto drain valve

