

DLR5040A-WE Non-CE

Screw Fastening Counter



Specifications

Model	DLR5040A-WE
Count	1 - 99
Counting Method	Count-up / Count-down
Count Correction Function	Count normal fastening only
Self Adjustable Timer Setting	0.01 to 0.99 sec.
Work Detection Function	Yes (1 terminal) / No
External Count Input	2 terminals (PARTS A / PARTS B)
Work Installation Timer Setting	0 to 9.5 sec.
OK Output Timer Setting	0 to 9.5 sec.
NG Alarm	ON(1) / ON(2) / OFF
OK Buzzer	ON(1) / ON(2) / ON(3) / OFF
Count Return Function	ON / OFF
NG Judge Timing	WORK SET / DRIVER ON
Automatic / Manual OK Judge	AUTO / MANUAL
Screwdriver Lock Function	ON / OFF
Multiple Link	Up to 10 counters can be connected.
External Inputs on Terminal Block	SENSOR / RESET / LINK-IN / PARTS A / PARTS B
External Outputs on Terminal Block	OK / NG / LINK-OUT
Parameter Memory	Parameters stored in internal nonvolatile memory
Input Voltage	100 - 240 V AC, 50/60 Hz
External Dimensions (mm [inch])	W100 x D120 x H60 [W3.94" x D4.72" x H2.36"]
Mass (g [lbs])	470 [1.04]

Accessory: 2 m cord with UL three-prong plug. This product is for use outside Japan.

Features

For prevention of human fastening errors and enhanced fastening management accuracy

- Ideally suited for the assembly lines of vehicles and electrical equipment requiring reliable screw fastening
- The controller receives signals from electric screwdrivers to provide highly reliable screw fastening control
- Count Return Function: When a screw is loosened, a reverse signal output from the electric screwdriver reverses the count by one
- The Count Correction Function does not count elevated screws or double fastening
- Input voltage range from 100 to 240 V AC is acceptable in any part of the world  
(The screwdrivers to be used in combination with the counter require input power supplies that are written on the respective nameplate)
- Link Connection Function: You can build up a simple sequential screw tightening system by connecting the DLR5040A-WE screw tightening counters in series without using any external controller such as a programmable controller
- Driver Lock Function prevents unexpected start of screwdrivers
- Compact and Lightweight (Compared with our conventional models decreased by 30 % in volume and by 38 % in mass)
- SPC type screwdrivers for DLR5040A-WE are designed on the basis of established transformerless screwdrivers

LINK Function

When counters are connected and activated in the screw fastening sequence as shown below, all screwdrivers are on standby except the first one in the sequence. Only when the first screw fastening is finished, can the next screwdriver change from standby to ready. When the last fastening in the sequence is finished, the first screwdriver is once again ready and the sequence can be repeated again.

N.B. Up to 10 screwdriver/counter sets can be connected to the LINK.



Example of use together with a sensor available in the market

DLR5340-WE Non-CE



Specifications

Model	DLR5340-WE
Count	0 - 99
Counting Method	Count-up / Count-down
Count Correction Function	Count normal fastening only
Self Adjustable Timer Setting	0.01 to 2.50 sec.
Work Detection Function	Yes (1 terminal) / No
Work Installation Timer Setting	0 to 9.5 sec.
OK Output Timer Setting	0 to 9.5 sec.
NG Alarm	ON(1) / ON(2) / OFF
OK Buzzer	ON(1) / ON(2) / ON(3) / ON(4) / ON(5) / OFF
Count Return Function	ON / OFF
Screwdriver Lock Function	ON / OFF
Screwdriver Cord Connection	Single cord connection (Signal and power lines)
External Inputs on Terminal Block	SENSOR / RESET / TORQUE CHECK / ch1/2/3
External Outputs on Terminal Block	OK / NG / COUNT-UP / DRIVER A/B/C
Input Voltage	100 - 240 V AC, 50/60 Hz
External Dimensions (mm [inch])	W150 x D120 x H60 [W5.91" x D4.72" x H2.36"]
Mass (g [lbs])	620 [1.37]

Accessory: 2 m cord with UL three-prong plug. This product is for use outside Japan.

Features

Up to three sets screwdrivers can be connected to one counter

- Up to eight kinds of screw fastening conditions can be stored in internal memory for a wide variety of assembly work
- Count-up signal outputs
- Space saving
- The Count Correction Function does not count elevated screws or double fastening as fastening errors
- Count Return Function: When a screw is loosened, a reverse signal output from the electric screwdriver reverses the count by one

# Dedicated Screwdrivers for DLR5040A-WE and DLR5340-WE Non-CE

Small



Big

## Specifications

Specifications		Miniature Screw (1.0 - 3.5 mm)					
Model	Lever Start	DLV7020-SPC	DLV7030-SPC	DLV7031-SPC	-	-	-
	Push to Start	-	-	-	DLV8020-SPC	DLV8030-SPC	DLV8031-SPC
Input Voltage		100 V AC, 50/60 Hz					
Torque Adjustment		Stepless					
Torque (Nm [lbf-in])		0.05 - 0.55 [0.4 - 4.9]	0.30 - 1.10 [2.7 - 9.7]	0.30 - 1.00 [2.7 - 8.9]	0.10 - 0.55 [0.9 - 4.9]	0.30 - 1.10 [2.7 - 9.7]	0.30 - 1.00 [2.7 - 8.9]
Free Speed (min <sup>-1</sup> )		900	650	1200	900	650	1200
Power Consumption (W)		Approx. 25		Approx. 30	Approx. 25		Approx. 30
Screw Size (mm)	Machine Screw	1.0 - 3.0	2.0 - 3.5	2.0 - 3.0	1.0 - 3.0	2.0 - 3.5	2.0 - 3.0
	Tapping Screw	1.2 - 2.6	2.0 - 3.0		1.2 - 2.6	2.0 - 3.0	
Bit Type		A					
Mass (g [lbs])		380 [0.84]			390 [0.86]		
Cord Length (m)		3 (with connector)					
Bit Grounding		Equipped as standard					

		Machine Screw(2.6 - 8.0 mm)					
Model	Lever Start	DLV7120-SPC	DLV7130-SPC	DLV7140-SPC	DLV7231-SPC	DLV7241-SPC	
	Push to Start	DLV8120-SPC	DLV8130-SPC	DLV8140-SPC	DLV8231-SPC	DLV8241-SPC	
Input Voltage		100 V AC, 50/60 Hz *1					
Torque Adjustment		Stepless					
Torque (Nm [lbf-in])		0.35 - 0.70 [3.10 - 6.20]	0.50 - 1.70 [4.4 - 15.1]	1.20 - 3.00 [10.6 - 26.6]	0.50 - 1.70 [4.4 - 15.1]	1.20 - 3.00 [10.6 - 26.6]	
Free Speed (min <sup>-1</sup> )		1000		700	2000	1200	
Power Consumption (W)		35			45		
Screw Size (mm)	Machine Screw	2.6 - 3.0	2.6 - 4.0	3.5 - 5.0	2.6 - 4.0	3.5 - 5.0	
	Tapping Screw	2.3 - 3.0	2.5 - 3.5	3.0 - 4.0	2.5 - 3.5	3.0 - 4.0	
Bit Type		B *2					
Mass (g [lbs])		710 [1.57] (7100series) / 570 [1.48] (8100series)			710 [1.57] (7200series) / 670 [1.48] (8200series)		
Cord Length (m)		3 (with connector)					
Bit Grounding		Equipped as standard					

		Machine Screw (2.6 - 8.0 mm)	
Model	Lever Start	-	DLV7251-SPC
	Push to Start	DLV8150-SPC	DLV8251-SPC
Input Voltage		100 V AC, 50/60 Hz *1	
Torque Adjustment		Stepless	
Torque (Nm [lbf-in])		2.0 - 4.5 [17.7 - 39.8]	
Free Speed (min <sup>-1</sup> )		450	700
Power Consumption (W)		45	
Screw Size (mm)	Machine Screw	4.5 - 6.0	
	Tapping Screw	4.0 - 5.0	
Bit Type		C	
Mass (g [lbs])		810 [1.79]	
Cord Length (m)		3 (with connector)	
Bit Grounding		Equipped as standard	

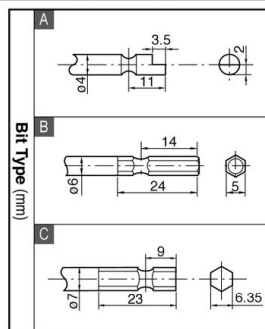

		Machine Screw(2.6 - 8.0 mm)					
Model	Lever Start	DLV30A06L-SPC	DLV30A12L-SPC	DLV30A20L-SPC	DLV45A06L-SPC	DLV45A12L-SPC	DLV70A06L-SPC
	Push to Start	DLV30A06P-SPC	DLV30A12P-SPC	DLV30A20P-SPC	DLV45A06P-SPC	DLV45A12P-SPC	DLV70A06P-SPC
Input Voltage		100 V AC, 50/60 Hz *1					
Torque Adjustment		Stepless					
Torque (Nm [lbf-in])		0.4 - 1.6 / 1.2 - 3.0 [3.5 - 14.2 / 10.6 - 26.6]			2.0 - 4.5 [17.7 - 39.8]		3.8 - 7.0 [33.6 - 62.0]
Free Speed (min <sup>-1</sup> )		650	1200	2000	650	1200	650
Power Consumption (W)		45					
Screw Size (mm)	Machine Screw	2.6 - 5.0			4.5 - 6.0		5.0 - 8.0
	Tapping Screw	2.5 - 4.0			4.0 - 5.0		4.5 - 6.0
Bit Type		B *2			C		
Mass (g [lbs])		700 [1.54]			870 [1.92] with pistol grip		
Cord Length (m)		3 (with connector)					
Bit Grounding		Equipped as standard					

\*1: Please contact us for other voltage availabilities. \*2: Please contact us for 6.35 mm bit type.

## Optional Accessories



### Torque Adjustment Ring Cover

DLW5200: DLV7100/7200/8100/8200-SPC  
DLW5300: DLV7000/8000-SPC

- This minimizes tampering or accidental turning of the torque adjustment ring once the torque is set.
- Flanged coupling DLW9011 can not be mounted on SPC type



### Pistol Grip

DLW2300: DLV7100/7200/  
8100/8200/30/45/70-SPC

- Suitable for horizontal operation



### TD04061 SPC cord for commercial power source (optional)

- Dedicated screwdrivers can be directly plugged in commercial power source.